

**Spanish River High School  
Countess de Hoernle Theatre**



**Leasing Information Packet**

# **Table of Contents**

<b>General Contact Information</b>	<b>3</b>
<b>Leasing Information</b>	<b>4</b>
<b>Map and Directions</b>	<b>6</b>
Shipping Information	
Loading Dock Information	
Site Plan	
<b>Seating Capacity/Chart</b>	<b>8</b>
<b>Stage Specifications</b>	<b>10</b>
Ground Plan	
<b>Rigging Specifications</b>	<b>12</b>
<b>Sound and Communication</b>	<b>14</b>
<b>Lighting and Audio-Visual</b>	<b>15</b>
<b>Dressing Rooms/Support Spaces</b>	<b>20</b>

**Countess de Hoernle Performing Arts Theatre  
at Spanish River Community High School**

5100 Jog Road  
Boca Raton, Florida 33496  
Main Office (561) 241-2200  
Monday-Friday  
7am – 3pm  
Main Fax (561) 241-2236



The Countess de Hoernle Theatre is a state of the art facility featuring a fully equipped control room, working stage with orchestra pit, and comfortable, scaled, padded seating for 800 patrons located on the campus of Spanish River Community High School. The lobby features a concession area, ticket booths and restrooms.

Theatre Manager

Christina Anderson-Lauar (561) 241-2286

[christina.andersonlauar@palmbeachschools.org](mailto:christina.andersonlauar@palmbeachschools.org)

## **LEASING INFORMATION**

### **Rental Rates**

- Theatre Space
  - \$153.00/hour (Non-profit)
  - \$241.00/hour (Profit)
- Personnel
  - \$183.00/hour (Non-profit/profit) – for all events, includes technical manager, base crew of 3, police officer, and custodian
  - \$16.00/hour (Non-profit/profit) – as needed per each additional crew member
- Orchestra Pit Set Up/Restore
  - \$350.00 (Non-profit/profit)

### **Terms**

1. All rentals must supply a copy of your Liability Insurance Certificate with “School Board of Palm Beach County” named as certificate holder and additional insured for the amount of \$1,000,000. Insurance may be purchased from the School District of Palm Beach County. Please request rates if interested. We also require a Waiver of Subrogation with the COI.
2. If the lessee is using the facility for any type of dance performance or event, we will also require Participant Coverage. The limit for this coverage is \$25,000.
3. For profit rentals you must supply a current (active) business license or State of Florida Corporation Status showing active status.
4. For Non-profit rentals you must supply the following –
  - a. Documentation of non-profit status (IRS Letter granting 501 (c)(3) Status) or State of Florida Corporation Status showing active non-profit status.
  - b. Sales Tax exemption certificate (if applicable)
5. Full payments and a signed lease are due one week prior to rental.
6. Additional personnel may be required for specific technical requests.
7. There is a two hour minimum for all personnel.
8. Persons operating the fly rail, weights, and spots must be qualified by our technician to avoid possibility of injury or

damage. Lessees are responsible for all damages to the facility and equipment.

9. Ushers are not included, but are available if needed. SRCHS ushers will be required if any food and/or drinks will be sold. There is no food or drinks allowed in the theatre other than bottled water.
10. If food (other than pre-packaged) will be served a copy of the restaurant's current Health Department Certificate and/or Caterer's License is required. Please advise us in advance if food needs to be "prepared" on-site, utilizing our facilities.
11. All events are required to have the district's event disclaimer (below) placed in a prominent place on all websites and advertising materials and to provide copies of website pages and all advertising materials that are produced and/or distributed.  
*"[Name of Lessee] is not affiliated with or endorsed by the School Board of Palm Beach County or Spanish River Community High School and the events/activities hosted by [Name of Lessee] on Spanish River Community High School's premises pursuant to a lease agreement shall not be construed as being conducted, funded, hosted, or sponsored by the School Board or Spanish River Community High School on behalf of [Name of Lessee]. The School Board and Spanish River Community High School undertake no responsibility for supervising or monitoring [ Name of Lessee]'s events/activities and will not be liable for any and all actions of [Name of Lessee] on Spanish River Community High School's premises."*

## **MAP and DIRECTIONS**

The theatre is conveniently located in the heart of Boca Raton and can be reached by several routes.

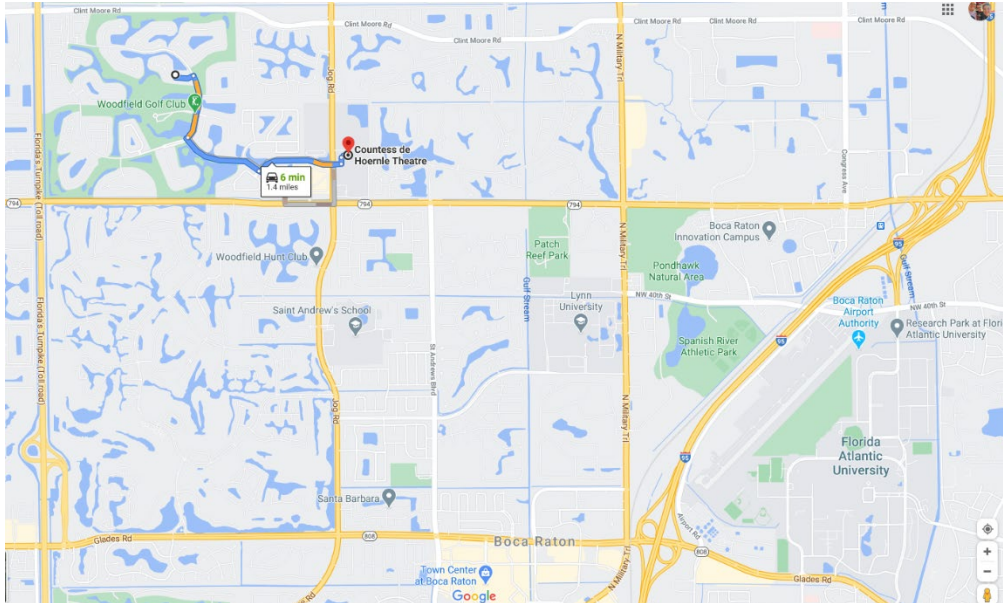

From Interstate 95:

Exit Yamato Road/Spanish River Blvd. Go west to Jog Road. Turn right to go north and Spanish River High School is on the right at the first light. The theatre is on the North side of the school.

From Florida Turnpike:

Exit at Glades Road (808). Go east to Jog Road. Turn left and go north. Pass Yamato Road and Spanish River High School is on the right at the first light. The theatre is on the North side of the school.

## **SHIPPING INFORMATION**

If you are shipping materials for your production prior to your arrival, please follow these instructions. Please notify the theatre staff in writing of all shipments include shipping company and tracking information. Spanish River High School accepts deliveries Monday – Friday, 8am – 3pm unless previous arrangements are made.

Spanish River High School  
c/o Christina Lauer for *(Your Company)*  
Deliver to Main Office  
5100 Jog Road  
Boca Raton, Florida 33496

## **LOADING DOCK**

The Countess de Hoernle loading dock is located at the north east end of the theatre building. The dock is 42" high, and the receiving doors are 9' wide by 10' high. The doors from the receiving area onto the stage are 9' wide by 10' high. Ramps and forklifts are not provided for loading/unloading off pallets/large trucks.



**COUNTESS DE HOERNLE SITE PLAN**

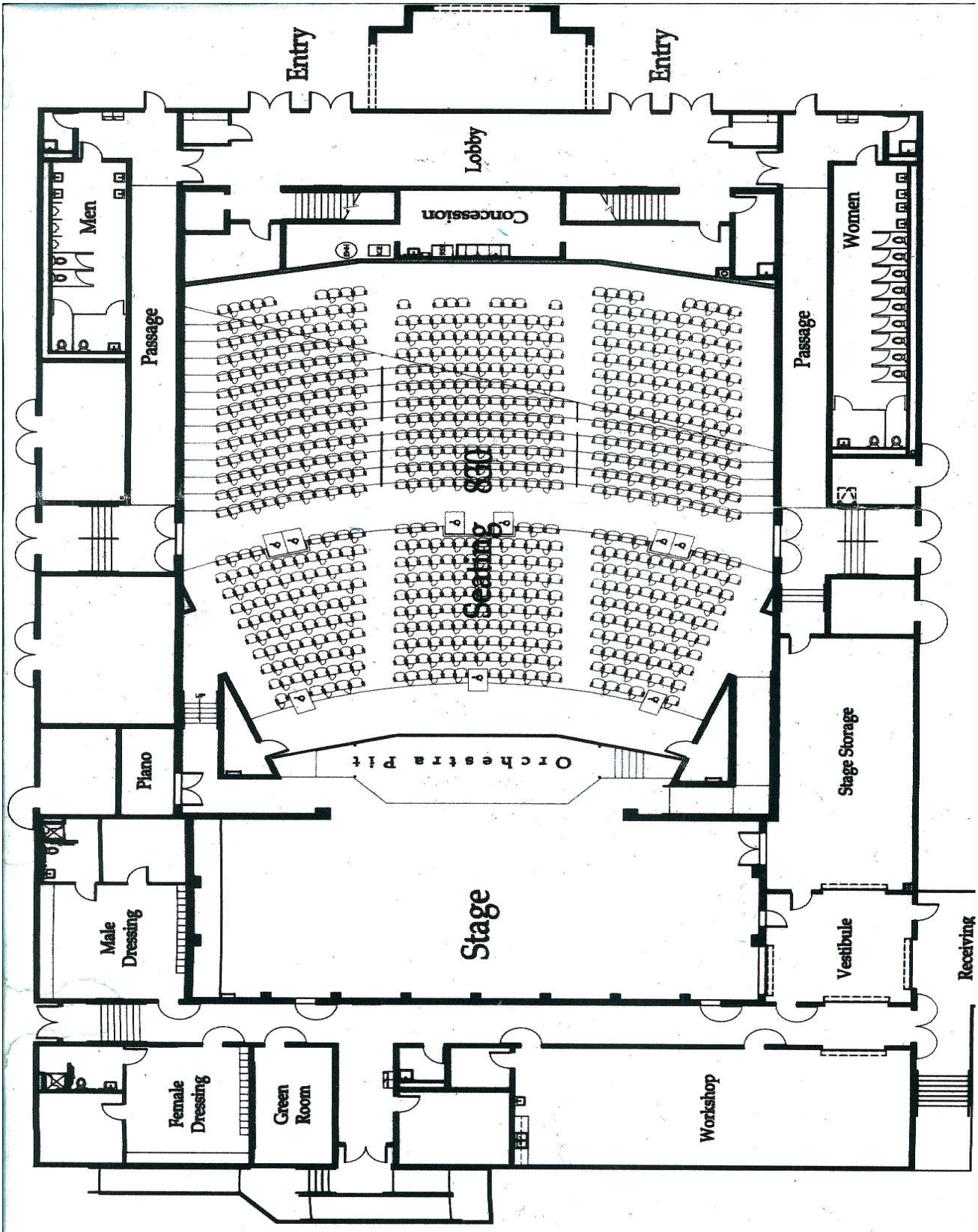



SPANISH RIVER COMMUNITY HIGH SCHOOL COUNTESS DE HOERNLE AUDITORIUM  
SEATING CHART

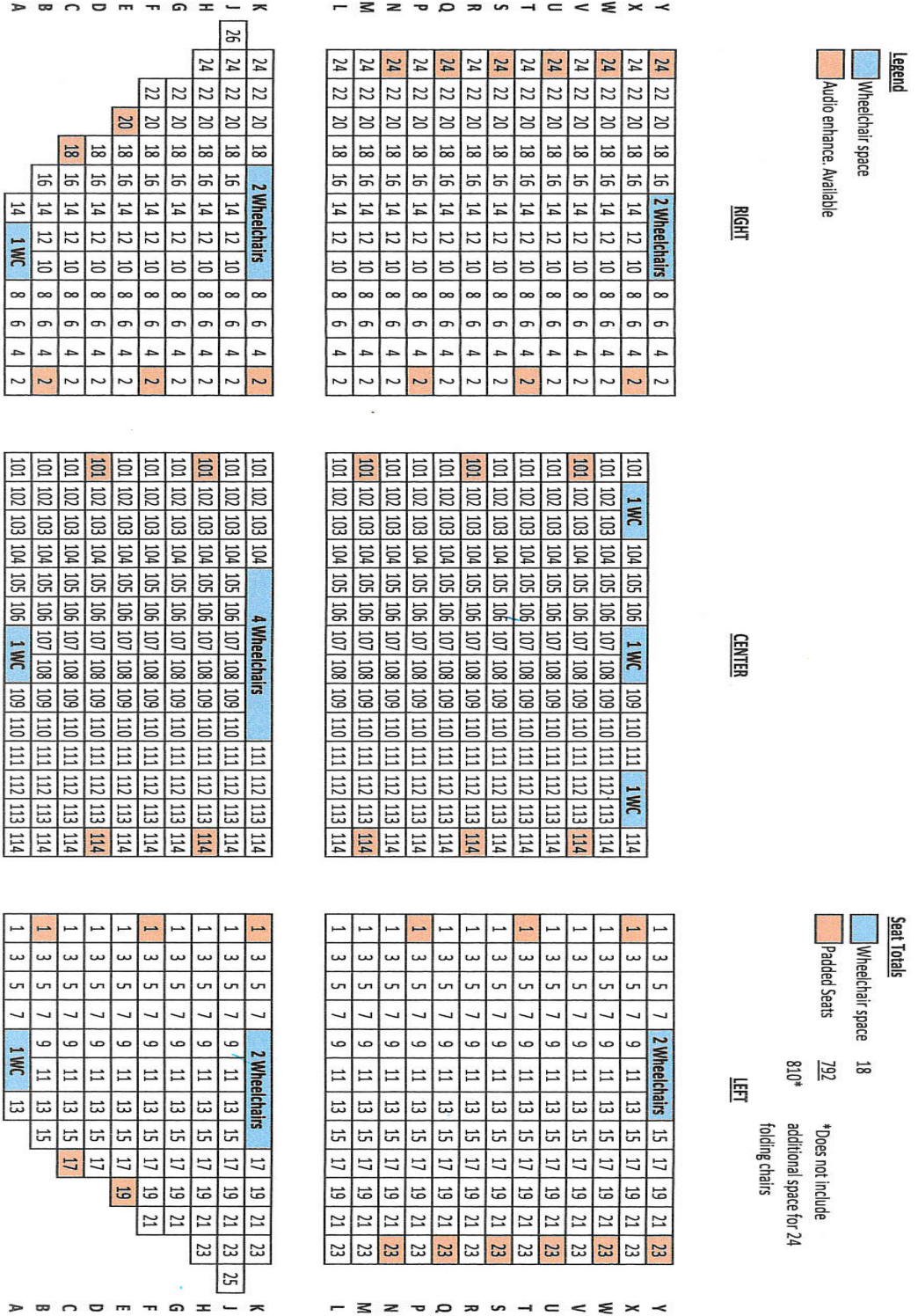

**SEATING INFORMATION AND CAPACITY**

792 padded seats with 18 Wheelchair accessible seats in our ADA Compliant Auditorium. We also have room for two rows of 24 folding chairs. Our theatre is a scaled elevation with no columns or obstructions.

## **STAGE SPECIFICATIONS**

STAGE FLOOR is a suspended wood floor. Any damage to the floor incurred by a production must be restored.

HEIGHT OF GRID	50'
HEIGHT OF PROSCENIUM	21'
WIDTH OF PROSCENIUM	42'
DEPTH OF STAGE (from Plaster Line to US wall)	33'
WIDTH OF STAGE (including wing space)	81'
APRON (at center point) (from Plaster Line)	10' – 8"
HEIGHT OF STAGE	3'
DEPTH OF ORCHESTRA PIT	12'
WIDTH OF ORCHESTRA PIT	40'

ORCHESTRA PIT does not have a hydraulic lift and therefore advance notice must be given if the cover needs to be removed.

MARLEY DANCE FLOOR (black) is NOT provided on site. Please contact the company below for floor rentals.

Rebekah's Dreams  
1029 N Florida Mango Road – Suite 3  
West Palm Beach, Florida 33409  
561-840-4071  
[www.rdeps.com](http://www.rdeps.com)

**STAGE DIMENSIONS - GROUND PLAN**

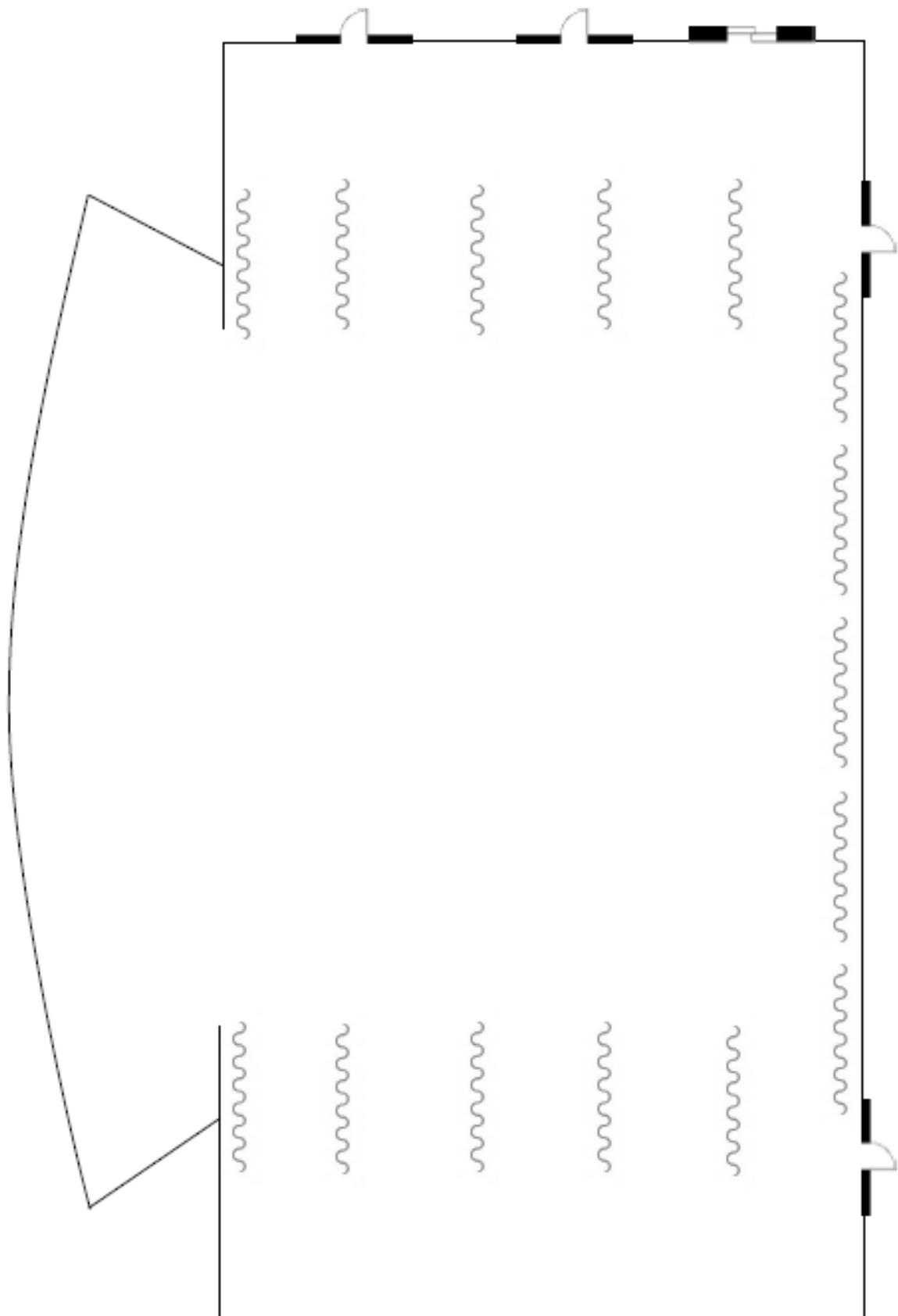

## **RIGGING SPECIFICATIONS**

Single purchase counterweight, hand operated line sets operated from the deck stage left.

NUMBER OF LINE SETS	26 line sets, 8" on center
GRID HEIGHT	50'
MAX WEIGHT PER ARBOR	1565 lbs
LENGTH OF BATTENS	62'

## **SOFT GOODS**

House Curtain – a manual counterweight velour curtain located 5" upstage from smoke pocket. Can be used as a guillotine or travel curtain and is operated from stage level down stage left. House curtain is permanent and cannot be moved or removed.

### Soft Goods Inventory

4	Black Velour borders (10' h x 48' w)
8	Black Velour legs (27' h x 10' w)
1	Concert Black Traveler (27' h x 48' w)
1	Black Mid Stage Traveler Curtain (27' h x 48' w)
1	Black sharks tooth scrim (27' h x 48' w)
1	White cyclorama (27' h x 48' w)

# **LINESET SCHEDULE**

## **Countess De Hoernle Line Schedule Rev. 11/19/20**

<b>SHOW:</b>			
<b>Line Set #</b>	<b>Position</b>	<b>House Hang</b>	<b>Show Hang</b>
FC	0'-6"	Fire curtain	
1	1'-2"	Main curtain	
2	1'-10"	#1 Black Border	
3	2'-6"	#1 Black Leg	
W1	3'-10"	#1 Electric	
W2	5'-2"	#2 Electric	
4	6'-6"		
5	7'-2"	Movers	
6	7'-10"		
7	9'-2"		
8	10'-6"	#2 Black Leg, #2 Black Border	
W3	11'-10"	#3 Electric	
9	13'-2"		
10	13'-10"	#3 Black Border	
11	14'-6"	Mid-stage Traveler	
12	15'-10"	Movers	
13	17'-2"	Projection Screen	
14	17'-10"	#3 Black Leg	
W4	19'-2"	#4 Electric	
15	20'-6"	Black Scrim	
16	21'-2"		
17	21'-10"		
18	23'-2"	#4 Black Border	
19	24'-6"		
20	25'-2"	#4 Black Leg	
21	25'-10"		
W5	27'-2"	#5 Electric	
22	28'-6"		
23	29'-2"		
24	29'-10"		
25	30'-6"	Cyclorama	
26	31'-2"	Concert Black Traveler	

## **SOUND and COMMUNICATIONS**

### **Front of House Console**

Yamaha LS9 Digital Console with 36 input channels

Source Gear –

TASCAM CD-RW90IMK2 CD player/recorder

Stereo Auxiliary Input

### **Wireless Microphones**

- 4 Shure ULX Handheld
- 12 Shure BLX4R Transmitters and Receivers
- 12 Electro-Voice RE-2 Wireless bodypack transmitters and receivers

### **Wired Microphones**

- 5 Shure SM58
- 6 Shure SM57
- 4 Audio Tech AT813a
- 3 Sound Barrier SB-815
- 1 Encore 300
- 1 Encore 100
- 1 Encore 100i

### **Backstage Communications**

Theatre is equipped with a Clear Com 2 channel intercom system; stations are located throughout the stage, house and control room.

Kawai Baby Grand Piano

(Pictures coming soon)

Formal Wooden Podium (with modesty panel)

(Pictures coming soon)

Legacy Acoustical Shell

(Information and pictures coming soon)

Conductor's Podium

(Information and pictures coming soon)

## **LIGHTING and AUDIO VISUAL**

The theatre is equipped with a permanent “house” lighting plot. It comes focused and colored per that plot. Any refocusing of equipment during load-in must be restored during the load-out. To obtain copies of the lighting plot contact the production office (available in PDF, DWG, or hard copy).

### Control

ETC EOS Element 60

### Followspots

2 Lycian 1275 Superstar 1.2 (1200w)  
Followspots are located in control room at FOH

### Complete Inventory (most of our inventory is hanging in our repertory plot)

Source Four Ellipsoidal 19 deg	25 Total
Source Four Ellipsoidal 26 deg	46 Total
Source Four Ellipsoidal 36 deg	48 Total
Source Four Zoom	24 Total
LED PAR cans	26 Total
Elation Platinum Spot LED Pro II Movers	12 Total
8” Fresnels	10 Total
Altman Ground Row and Sky Cyc Luminaire	10 Total
6 12’ booms w/ bases	
2 10’ booms w/ bases	
1 Genie Lift AWP-40S	

### Audio-Visual

16’ x 21’ Projection Screen  
Epson PU2113W 13K Lumen Projector – hookup on stage or tech booth

**MAGIC SHEET**

(Coming Soon)



**FOH PLOT**

(Coming Soon)

## **STAGE PLOT**

(Coming Soon)

## **Circuit Location**

### **Circuit Numbers**

1 – 10

11 – 20

21 – 30

31 – 36

37 – 42

43 – 48

49 – 54

55 – 87

88 – 102

103 – 117

118 – 132

133 – 152

153 – 156

157 – 160

161 – 164

165 – 168

### **Location**

FOH Catwalk HL

FOH Catwalk HCTR

FOH Catwalk HR

HL Lower Box Boom

HR Lower Box Boom

HL Upper Box Boom

HR Upper Box Boom

First Electric

Second Electric

Third Electric

Fourth Electric

Fifth Electric

DSR Stage Wall

DSL Stage Wall

USR Stage Wall

USL Stage Wall

**LOBBY**

There is a large lobby at the front entrance of the theatre that houses limited seating with a full concessions area. Concessions area has a concession window with stainless steel counters and drawers. It includes a convection oven, sinks, refrigerator and ice maker. Full kitchen is available in the cafeteria, however additional charges will apply. Accessible restrooms are located to the north (Women’s) and south (Men’s) of the lobby.



**TICKET BOOTH**

We have (2) ticket windows, one at either end of the lobby, that include a counter, cash drawers, phone and intercom. (Pictures coming soon)

**DRESSING ROOMS**

All dressing rooms and support rooms are located directly behind the stage, and are accessible from either side of the stage. All rooms are equipped with showers, toilets, mirrors, chairs, and costume racks. There is a counter running the length of one wall. There are audio monitors throughout the area.

Dressing Room (Male)

Fits approx. 10 – 15 people

17’ w x 20’ l

Dressing Room (Female)

Fits approx. 10 – 15 people

20’ w x 20’ l



### **GREEN ROOM/WARM-UP SPACE**

The green room is 21' x 11' and has a small refrigerator. There is an audio and video feed from the stage. It can be used as a catering room, a wardrobe room, a production office, or a rehearsal/warm-up room.



### **SUPPORT SPACES**

The theater is not equipped with office space for clients. We do not have phone lines or internet connection in the dressing rooms or green room, other than a guest wi-fi that may be accessed. In the instance that a larger space is needed we do offer the cafeteria which is adjacent to the theatre. This is an added cost to the lease. Please contact us for details.

### **BACKSTAGE ENTRANCE**

There is an outside entrance directly to the backstage area from the south east end of the building that may be used for performer entrance and exit.